

# Sheboygan Avenue Community Garden in Rennebohm Park Madison, Wisconsin

## Handbook 2020

Celebrating our 40th Year!



# Welcome to Sheboygan Avenue Community Garden located in Rennebohm Park

We encourage you to visit the garden often. You will be surprised how many things ripen almost overnight, or how many weeds have set seed since your last visit.

Our social events offer a chance to get acquainted with neighbors from around the world. Did you know that more than a dozen languages are spoken here? Or that our age range is almost a century? But we all speak 'gardening'.

Our commonality is a love of gardening. Each of us follows our own practices for growing vegetables and flowers and we learn from each other about new plants. The mixture makes for our famous diverse potluck dinners. Be sure to join us.

If you have any questions, would like to be more involved, or need assistance, please do not hesitate to contact us. This is a community of gardeners!

Sincerely,

The Garden Steering Committee

Sheboygan Avenue Community Garden

PO Box 5011

Madison, WI 53705

[www.sheboygancommunitygarden.org](http://www.sheboygancommunitygarden.org)

# Steering Committee Contacts

Coordinator - Jim Baumann	<a href="mailto:coordinator@sheboygancommunitygarden.org">coordinator@sheboygancommunitygarden.org</a>
Registrar - Emma Sams	<a href="mailto:registrar@sheboygancommunitygarden.org">registrar@sheboygancommunitygarden.org</a>
Treasurer - Yuhua Li	<a href="mailto:yuhualius818@sheboygancommunitygarden.org">yuhualius818@sheboygancommunitygarden.org</a>
Communication Secretary - Julie Grim	<a href="mailto:communication@sheboygancommunitygarden.org">communication@sheboygancommunitygarden.org</a>
Past Coordinator - Cindy Statz	<a href="mailto:Cindysta@sheboygancommunitygarden.org">Cindysta@sheboygancommunitygarden.org</a>
Time Monitor - Geren Zhang	<a href="mailto:timekeeper@sheboygancommunitygarden.org">timekeeper@sheboygancommunitygarden.org</a>
Plot Monitor - Ruth Cadoret	<a href="mailto:plotmonitor@sheboygancommunitygarden.org">plotmonitor@sheboygancommunitygarden.org</a>
Tools/Equipment - Jim Dudley	<a href="mailto:jim@berntsen-foundry.com">jim@berntsen-foundry.com</a>
Member at Large - Pat Soderholm	<a href="mailto:pm.sode@gmail.com">pm.sode@gmail.com</a>

The Gardens Network Website: [www.danecountycommunitygardens.org](http://www.danecountycommunitygardens.org)

Please visit our website: [www.sheboygancommunitygarden.org](http://www.sheboygancommunitygarden.org)

**Problems? Dial 9-1-1 for emergencies.  
For non-emergency, garden problems regarding  
thievery or mischief contact Madison Police at  
(608) 255-2345**

# Sheboygan Community Garden Calendar 2020

- ~~April 18, 2020 Work Day~~
  - ~~Rain date April 25, 2020~~
- **May 16, 2020 Work Day**
  - Rain Date May 23, 2020
- The water will be turned on by the Parks Department when they have determined that there is no further danger of frost.
- Rhubarb Fest in May - Date and time to be determined.
- **June 7, 2020** Garden needs to be planted or plot may be reassigned.
- **June 20, 2020 Work Day**
  - Rain Date June 27, 2020
- **June 20, 2020 Summer Solstice Garden Brunch with Music 12:00 Noon**
- Zucchini Fest in July - Date and time to be determined
- **July 18, 2020 Work Day**
  - Rain Date July 25, 2020
- Anything-but-Zucchini Fest in August - Date and time to be determined.
- **August 15, 2020 Work Day**
  - Rain Date August 22, 2020
- **September 19, 2020 Work Day**
  - Rain Date September 26, 2020
- Annual Fall Meeting (first week October - Date TBD)
- **October 17, 2020 Work Day**
  - Rain Date October 24, 2020
- The first week of October (no exact date) the water will be shut off by the Parks Department.
- **October 20, 2020** Garden Plots need to be cleaned for winter.
- **November 7, 2020 Work Day**
  - Rain Date November 14, 2020

# Sheboygan Avenue Community Garden

## New Gardener Tips

Please be aware that visiting the garden often is a **MUST**.... We suggest at least 2 times per week. 3-4 times is even better so that the visits can be brief and still be productive.

Learn how temperature and wind affect soil moisture and plant growth.

Look at other gardens to see what is growing well.

Catch weeds and pull them out while they are still small.

Talk to other gardeners to learn what works well for them. (Be aware that gardeners are an opinionated lot and there is more than one way to garden successfully.)

### Site Preparation:

- **WEED.** Dig large weeds and knock the soil from the roots. Keep the soil, get rid of the weed.
- Lay out your garden bed (perpendicular to slope is best for erosion control if you plot is sloped).
- Dig as needed to loosen soil or add compost. Plants grow best in non-compacted soil.

### What to grow:

- Things you will use or enjoy.
- Dwarf or compact varieties.
- Disease resistant varieties.

### When to plant:

- Read the seed packet. It will have lots of useful information.

## Watering:

- Keep seed beds consistently moist, not drenched. Use a gentle spray or watering can so seeds don't get washed away. Drizzle water on soil in root area. Pay close attention (visit often) to young plants until they are well established and can go a week without water.

## Mulch:

- A thin layer of mulch helps to hold in soil moisture and will suppress (not stop) weed germination. It also keeps soil cool. Some plants like cooler soil and some like warmer soil.

## Weeding: (Last but not Least!)

- Plan to weed at least once per week (visit often). Weeds are abundant and grow fast. Faster than anything you have planted. When weeds are small, they can be easily removed by scraping the soil with a hoe. They can be left right there to die. Weeds large enough to require pulling can also be left to die. Once your plants are big enough, the pulled weeds can be tucked right under them - out of sight.

# Good Neighbor Rules We Agree To Follow

- 1. We are an organic garden.** Organic gardens use composted manure, homemade compost and leaf mulch in place of chemical fertilizers. Synthetic fertilizers, pesticides, insecticides, herbicides and fungicides are NOT allowed. Only OMRI Listed for Organic Use or UW Extension approved products may be used, such as NEEM or Safer's Insecticidal Soap. For more information on botanicals, microbials, and inorganic pesticides visit [wimastergardener.org/?q=OrganicPesticides](http://wimastergardener.org/?q=OrganicPesticides). There are also many structural approaches - companion planting, target crops, traps, etc.....please contact a garden board member for additional information. NO storage of garden chemicals is allowed within the plot.
- 2. Garden plots must be reasonably utilized for growing food or flowers for members' use only;** flowers, herbs, and vegetables grown at the garden cannot be sold.
- 3. Gardeners are responsible for clearing weeds** in their garden including the garden fence lines bordering their garden, during the gardening season and clean up at end of the year.
- 4. Gardeners are responsible for harvesting produce** in a timely manner.
- 5. Gardeners shall not attach plant supports to the perimeter fence or allow plants to grow on or through the fence.**
- 6. Gardeners shall NOT move any corner stakes, plot number stakes, boundary marking string and/or plot numbers.**

7. **Gardeners may not grow invasive plants**, such as mint, horseradish and raspberries.
8. **Gardeners may NOT enter or take anything from someone's plot** without specific permission from the gardener. This includes watering cans and personal tools.
9. **Gardeners must place plants** in a way that does not block sunlight from their neighbor's plots and as a safety measure, maintain reasonable visibility into the garden. In general, plants and support structures should be less than 4 feet tall (the height of the perimeter fence). A limited number of taller plants and structures will be allowed as long as they do not shade a neighbor and as long as they do not comprise more than 15% of the plot area. In general, plants within 2' of a neighbors' border should be 3' tall or less if they have the potential to shade the neighbor. Any plant over 3 feet in height must be removed or trimmed if it is shading a neighbor. Acceptable areas for tall plants will vary with a plot's location and size. Some plots will have better opportunities for tall plants than others. Think carefully about where the light is coming from at all times of day before placing your tall plants. Our goal with tall plant restrictions is to maintain decent visibility into all parts of the garden from anywhere inside or outside of the garden. We do not want any large, "solid walls" of plants over 4-foot high, so don't make one long row of tall plants. The taller plantings should have shorter plantings between them.
10. **Gardeners are responsible for keeping plants and equipment within their plot.** Please keep in mind the size of your plants when mature. Allow enough room away from plot lines so that plants are set where they will not spill over into other plots or paths. Plants should be placed away from your plot borders - no less than  $\frac{1}{2}$  the full, mature size of the plants you are growing. Your plants must stay within the boundary of your plot. Plants that fall outside of your plot will be trimmed. The Garden Board encourages the use of compact plants.



11. **Garden structures must be self-supporting and blend into the garden landscape and be aesthetically pleasing.** Structures and edging material should be generally available at garden supply stores or may be found wood branches. **Plot border fencing structures taller than 24" are not allowed.** White structures taller than 24" are not allowed. Please contact coordinator or plot monitor for permission to use any other type of structural material.
12. **Gardeners are responsible for the care of their plot.** Please contact the garden coordinator whenever someone other than you will be caring for or harvesting in your plot. Discuss your plan to address watering, weeding, and harvesting. Anyone working/harvesting in a plot besides the assigned gardener must be with the assigned gardener or have gone through gardener orientation.
13. **Garden plots are checked regularly by the plot monitor.** When the plot monitor becomes aware of a rule violation (e.g. use of not approved garden structures) or a condition negatively affecting surrounding gardens (e.g. a bad bug infestation) the offending gardener will receive a communication stating the nature of the problem and when the problem must be corrected. The time given will vary depending on the urgency of the problem. If the problem is not corrected in time the garden board will arrange for someone to enter your plot and fix the problem. If this happens you will be assigned work hours to make up for the work done in your plot.
14. **Gardeners must remove trash, unused garden equipment and diseased garden material from plots.** Park bins may be used to dispose of non-vegetative material. All vegetative material must be disposed of by gardener. Gardeners are encouraged to compost vegetative matter in their plot.
15. **Required Work Hours:** Gardeners are required to contribute a minimum of 4 work hours per 100 sq. foot plot, per year, and 6 work hours per 200 sq. foot plot per year, caring for the common areas. Volunteers are needed to care

for the Food Pantry plots and community flower beds. Contributing more hours is encouraged. Gardeners are responsible for reporting their work hours to the timekeeper. Failure to complete and report required work hours may result in loss of garden plot the following year.

Physically challenged gardeners may be exempt from doing physical work hours. There are many ways to contribute. Contact the Garden Coordinator to discuss options or possible exemption.

Work days are scheduled monthly (see calendar). Independent work can be arranged - contact the Garden Coordinator.

Work Sign-in Sheet: Planned work days will have a sign in sheet available to report date, completed time, plot and name. Independent hours must be arranged by Garden Coordinator and reported via email to timekeeper.

16. **Water Usage:** It is vital to conserve water. Apply water onto ground at base of plant. Avoid overhead sprinkling as it promotes mildew and fungal diseases. Soaker hoses are not allowed. Do not leave hoses unattended. After watering, be sure to turn off spigot. For Garden Watering Best Practices, visit the SACG Website: [www.sheboygancommunitygarden.org](http://www.sheboygancommunitygarden.org)
17. **Tools:** The garden owns tools, carts, wheelbarrows, and buckets for all to use. When you finish using tools, clean them and store neatly:
  - ✓ Wheelbarrows and carts should be emptied after rain to avoid pools of stagnant water where mosquitos may breed
  - ✓ Power tools, mowers, and rototillers are to be used only by members trained and approved by the Grounds Committee
  - ✓ Always close and latch the shed door
18. **Pets are not allowed inside the perimeter fence of the garden.**

19. **Fall Clean-up** ~ All gardens must be cleaned of dead plant material, weeds and plant supports by the second week in October. Gardening of fall crops may continue as long as weather permits.
20. **Penalties** (to be decided by Garden committee) for not following Good Neighbor rules:
- ✓ No guarantee to have the same plot the next year
  - ✓ Reduction in plot size for the next year
  - ✓ Name moved to the bottom of plot waiting list
  - ✓ No plot assignment for the next year

## Garden Notes:

**Wood Chips** may be provided from time to time and are kept in piles near the north entrance. Please take only as much as you need so the supply is shared with all.

**Garden Compost** ~ Currently, there is no room for a large compost site at the garden. Individuals may create compost within their plot. Compost is decomposed organic matter. It can include weeds, dried grass cuttings, chopped leaves, and leafy kitchen scraps. It is used to enrich soil and can be added every time soil is turned. Compost does not include animal products (except egg shells) or pet waste. Weed seeds, sticks, stones, plastic and other inorganic waste should be excluded. Please take home any diseased plants or plant material.

**Food Pantry Plot** ~ The Garden has a designated Food Pantry Plot. In addition, gardeners are encouraged to donate surplus produce from their own plots to local food pantries.

# SHEBOYGAN AVENUE COMMUNITY GARDEN

## AT RENNEBOHM PARK

### PLOT MAP

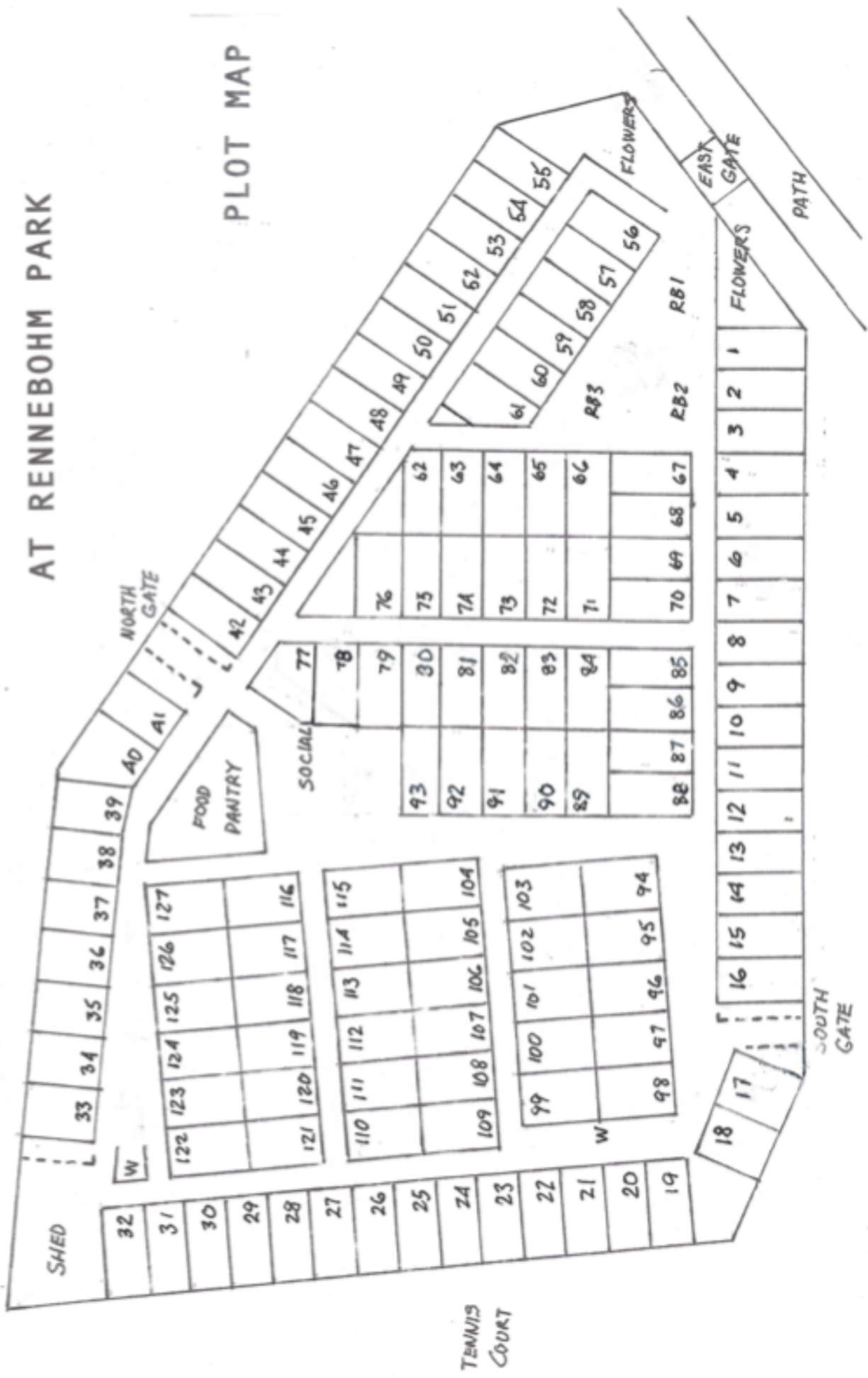

1/13/2019  
REV. 4/13/2019