

Sheboygan Avenue Community Garden in Rennebohm Park Madison, Wisconsin

Handbook 2022

Celebrating our 42nd Year!



Welcome to Sheboygan Avenue Community Garden located in Rennebohm Park

We encourage you to visit the garden often. You will be surprised how many things ripen almost overnight, or how many weeds have set seed since your last visit.

Our social events offer a chance to get acquainted with neighbors from around the world. Did you know that more than a dozen languages are spoken here? Or that our age range is almost a century? But we all speak 'gardening'.

Our commonality is a love of gardening. Each of us follows our own practices for growing vegetables and flowers and we learn from each other about new plants. The mixture makes for our famous diverse potluck dinners. Be sure to join us.

If you have any questions, would like to be more involved, or need assistance, please do not hesitate to contact us. This is a community of gardeners!

Sincerely,

The Garden Steering Committee

Sheboygan Avenue Community Garden

PO Box 5011

Madison, WI 53705

www.sheboygancommunitygarden.org

Steering Committee Contacts

Coordinator - Jim Baumann	coordinator@sheboygancommunitygarden.org
Registrar - Cindy Statz	registrar@sheboygancommunitygarden.org
Treasurer - Yuhua Li	yuhualius818@sheboygancommunitygarden.org
Communication Secretary - Julie Grim	communication@sheboygancommunitygarden.org
Past Coordinator - Cindy Statz	cindysta@sheboygancommunitygarden.org
Time Monitor - Geren Zhang	timekeeper@sheboygancommunitygarden.org
Plot Monitor - Jamie LaMantia	plotmonitor@sheboygancommunitygarden.org
Tools/Equipment - Jim Dudley	jim@berntsen-foundry.com
Member at Large - Pat Soderholm	pm.sode@gmail.com
Member at Large - Ruth Cadoret	cadoretruth@gmail.com
The Gardens Network Website:	www.danegardens.net

Please visit our website: www.sheboygancommunitygarden.org

**Problems? Dial 9-1-1 for emergencies.
For non-emergency, garden problems regarding
thievery or mischief contact Madison Police at
(608) 255-2345**

Sheboygan Community Garden Calendar 2022

- **May** - Straw delivery date TBD
- **May** - The water will be turned on by the Parks Department when they have determined that there is no further danger of frost.
- **May 21, 2022** - Work Day (Rhubarb Fest)
- **June 4, 2022** - Garden needs to be planted or plot may be reassigned.
- **June 18, 2022** - Work Day (Summer Solstice Celebration)
- **June 21, 2022** - Actual Summer Solstice
- **July 16, 2022** - Work Day
- **August 20, 2022** - Work Day (Zucchini Fest)
- **September 17, 2022** - Work Day
- **October** - Annual Fall Meeting
- **October 15, 2022** - Work Day
- **October** - The first week of October (no exact date) the water will be shut off by the Parks Department.
- **October 29, 2022** Garden Plots summer crops need to be cleaned up for winter.
- **November 19, 2022** - Work Day if needed

Sheboygan Avenue Community Garden

New Gardener Tips

Please be aware that visiting the garden often is a **MUST**... We suggest at least 2 times per week. 3-4 times is even better so that the visits can be brief and still be productive.

Learn how temperature and wind affect soil moisture and plant growth.

Look at other gardens to see what is growing well.

Catch weeds and pull them out while they are still small.

Talk to other gardeners to learn what works well for them. (Be aware that gardeners are an opinionated lot and there is more than one way to garden successfully.)

Site Preparation:

- **WEED.** Dig large weeds and knock the soil from the roots. Use the weed as mulch in your plot.
- Lay out your garden bed (perpendicular to slope is best for erosion control if your plot is sloped).
- Dig as needed to loosen soil or add compost. Plants grow best in non-compacted soil.

What to grow:

- Things you will use or enjoy.
- Dwarf or compact varieties.
- Disease resistant varieties.

When to plant:

- Read the seed packet. It will have lots of useful information.

Watering:

- Keep seed beds consistently moist, not drenched. Use a gentle spray or watering can so seeds don't get washed away. Drizzle water on soil in root area. Pay close attention (visit often) to young plants until they are well established and can go a week without water. Please look at the Sheboygan Avenue Community Garden Website for watering guidelines.

Mulch:

- A thin layer of mulch helps to hold in soil moisture and will suppress (not stop) weed germination. It also keeps soil cool. Some plants like cooler soil and some like warmer soil.

Weeding:

- Plan to weed at least once per week (visit often). Weeds are abundant and grow fast. Faster than anything you have planted. When weeds are small, they can be easily removed by scraping the soil with a hoe. They can be left right there to die. Weeds large enough to require pulling can also be left to die. Once your plants are big enough, the pulled weeds can be tucked right under them - out of sight.

Please Be Aware: (last but not least)

- All community gardens, including ours, experience occasional thefts of produce, plants, decorative items and tools. Please think of what you may leave in your garden when you are not there.

Good Neighbor Rules We Agree To Follow

We are neighbors in several ways. With those using plots and paths next to our own plot, with park users and with people living in nearby dwellings. Our Good Neighbor rules intentions are to ensure we respect our neighbors' needs and enjoyment. Our actions in our own plot must not negatively impact neighboring plots and garden paths. We are, essentially, guests of the park, a public place, and have appearance guidelines to ensure the garden is attractive. And we have rules about plant height and placement that help preserve personal safety by maintaining sightlines throughout the garden.

- 1. We are an organic garden.** Organic gardens use composted manure, homemade compost and leaf mulch in place of chemical fertilizers. Synthetic fertilizers, pesticides, insecticides, herbicides, fungicides, dog, cat, and human waste are NOT allowed. Only OMRI Listed for Organic Use or UW Extension approved products may be used, such as NEEM or Safer's Insecticidal Soap. For more information on botanicals, microbials, and inorganic pesticides visit wimastergardener.org/?q=OrganicPesticides. There are also many structural approaches - companion planting, target crops, traps, etc..... please contact a garden board member for additional information. NO storage of garden chemicals is allowed within the plot.
- 2. Garden plots must be reasonably utilized for growing food or flowers for members' use only;** flowers, herbs, and vegetables grown at the garden cannot be sold.
- 3. Gardeners are responsible for clearing weeds** in their garden including the garden fence lines bordering their garden, during the gardening season and clean up at end of the year.

4. **Gardeners are responsible for harvesting produce in a timely manner.**
5. **Gardeners shall not attach plant supports to the perimeter fence or allow plants to grow on or through the fence.**
6. **Gardeners shall NOT move any Blue-Topped corner stakes, plot number stakes, boundary marking string and/or plot numbers.**
7. **Gardeners may not grow invasive plants, such as mint, horseradish and raspberries.**
8. **Gardeners may NOT enter or take anything from someone's plot without specific permission from the gardener. This includes watering cans and personal tools.**
9. **Gardeners must place plants** in a way that does not block sunlight from their neighbor's plots and as a safety measure, maintain reasonable visibility into the garden. In general, plants and support structures should be less than 4 feet tall (the height of the perimeter fence). A limited number of taller plants and structures will be allowed as long as they do not shade a neighbor and as long as they do not comprise more than 15% of the plot area. In general, plants within 2' of a neighbor's border should be 3' tall or less if they have the potential to shade the neighbor. Any plant over 3 feet in height must be removed or trimmed if it is shading a neighbor. Acceptable areas for tall plants will vary with a plot's location and size. Some plots will have better opportunities for tall plants than others. Think carefully about where the light is coming from at all times of day before placing your tall plants. Our goal with tall plant restrictions is to maintain decent visibility into all parts of the garden from anywhere inside or outside of the garden. We do not want any large, "solid walls" of plants over 4-foot high, so don't make one long row of tall plants. The taller plantings should have shorter plantings between them.

10. Gardeners are responsible for keeping plants and equipment within their plot. Please keep in mind the size of your plants when mature. Allow enough room away from plot lines so that plants are set where they will not spill over into other plots or paths. Plants should be placed away from your plot borders - no less than $\frac{1}{2}$ the full, mature size of the plants you are growing. Your plants must stay within the boundary of your plot. Plants that fall outside of your plot will be trimmed. The Garden Board encourages the use of compact plants.

11. Garden fences and gates must be self-supporting and blend into the garden landscape and be 24" in height or less. They must be made only of material intended to be used as fencing or gates such as chicken wire or hardware cloth. This type of product can be easily found at garden supply and hardware stores. Do not use things such as old window screens, metal shelving, old bed frames, mop handles, etc.

Structures within the plot such as a trellis or stakes should, in general, be 4' in height or less and be self-supporting. A small amount of taller structure is allowed - see rule #9 for exceptions. These structures should be made of the kind of material intended for plant supports, easily found in garden and hardware stores, or may be found wood branches from tree pruning. No white structures over 24" in height. When building a trellis, place it far enough from plot borders that your plants do not infringe on the neighbor or escape onto the perimeter fence. Do not use things such as old mop handles, bed frames and metal shelving for structures.

If you want to use a type of material for a structure or fence that does not meet these guidelines, please ask the garden coordinator, or plot monitor and we will consider your request.

- 12. Gardeners are responsible for the care of their plot.** Please contact the garden coordinator whenever someone other than you will be caring for or harvesting in your plot. Discuss your plan to address watering, weeding, and harvesting. Anyone working/harvesting in a plot besides the assigned gardener must be with the assigned gardener or have gone through gardener orientation.
- 13. Garden plots are checked regularly by the plot monitor.** When the plot monitor becomes aware of a rule violation (e.g. use of not approved garden structures) or a condition negatively affecting surrounding gardens (e.g. a bad bug infestation) the offending gardener will receive a communication stating the nature of the problem and when the problem must be corrected. The time given will vary depending on the urgency of the problem. If the problem is not corrected in time the garden board will arrange for someone to enter your plot and fix the problem. At times a notice of intent to enter individual plots to clear excessive amounts of weeds going to seed or to dig extremely noxious weeds such as thistle, ragweed, and velvetleaf will be in the form of an email sent to all gardeners stating this sort of work will be done on the next workday if the gardener has not done the work before the workday. If this happens you will be assigned work hours to make up for the work done in your plot.
- 14. Gardeners must remove trash,** unused garden equipment and diseased garden material from plots. Park bins may be used to dispose of non-vegetative material. All vegetative material must be disposed of by gardener. Gardeners are encouraged to compost vegetative matter within their plot.
- 15. Required Work Hours:** Gardeners are required to contribute a minimum of 3 work hours per 100 sq. foot plot, per year, and 5 work hours per 200 sq. foot plot per year, caring for the common areas. For 2022, please refer to the Registration Material Cover Letter sent to gardeners. Volunteers are needed to care for the Food Pantry plots and community flower beds. Contributing

more hours is encouraged. Gardeners are responsible for reporting their work hours to the timekeeper. Failure to complete and report required work hours may result in loss of garden plot the following year.

Physically challenged gardeners may be exempt from doing physical work hours. There are many ways to contribute. Contact the Garden Coordinator to discuss options or possible exemption.

Workdays are scheduled monthly (see calendar). Independent work can be arranged - contact the Garden Coordinator.

Work Sign-in Sheet: Planned workdays will have a sign in sheet available to report date, completed time, plot and name. Independent hours must be arranged by Garden Coordinator and reported via email to timekeeper.

16. **Water Usage: It is vital to conserve water.** Apply water onto ground at base of plant. Avoid overhead sprinkling as it promotes mildew and fungal diseases. Soaker hoses are not allowed. Do not leave hoses unattended. After watering, be sure to turn off spigot. For Garden Watering Best Practices, visit the SACG Website: www.sheboygancommunitygarden.org

17. **Tools:** The garden owns tools, carts, wheelbarrows, and buckets for all to use. When you finish using tools, clean them and store neatly:
 - ✓ Wheelbarrows and carts should be emptied after rain to avoid pools of stagnant water where mosquitos may breed
 - ✓ Power tools, mowers, and rototillers are to be used only by members trained and approved by the Grounds Committee
 - ✓ Always close and latch the shed door

18. **Pets are not allowed inside the perimeter fence of the garden.**

19. Fall Clean-up: Gardens must be cleaned of most dead plant material in the fall. This is best done in October and early November during the time period the city picks up garden waste. Gardens not cleared in time for the last city pick-up will be cleared by a volunteer and the plot's gardener will be assessed work hours. Plant supports should be taken up and laid neatly on the ground over winter. Gardening of fall crops may continue as long as weather permits. When these crops die, the dead plant material must be removed and taken home or to a city drop off site by the gardener. A plot can have an inch of mulch on top of the soil over winter. More than this attracts mice and voles.

20. Penalties (to be decided by Garden committee) for not following Good Neighbor rules:

- ✓ No guarantee to have the same plot the next year
- ✓ Reduction in plot size for the next year
- ✓ Name moved to the bottom of plot waiting list
- ✓ No plot assignment for the next year

Garden Notes:

Wood Chips may be provided from time to time and are kept in piles near the north entrance. Please take only as much as you need so the supply is shared with all.

Garden Compost ~ Currently, there is no room for a large compost site at the garden. Individuals may create compost within their plot. Compost is decomposed organic matter. It can include weeds, dried grass cuttings, chopped leaves, and leafy kitchen scraps. It is used to enrich soil and can be added every time soil is turned. Compost does not include animal products (except eggshells) or pet waste. Weed seeds, sticks, stones, plastic, and other inorganic waste should be excluded. Please take home any diseased plants or plant material.

Food Pantry Plot ~ The Garden has a designated Food Pantry Plot. In addition, gardeners are encouraged to donate surplus produce from their own plots to local food pantries.

My Garden Journal

SHEBOYGAN AVENUE COMMUNITY GARDEN

AT RENNEBOHM PARK

PLOT M

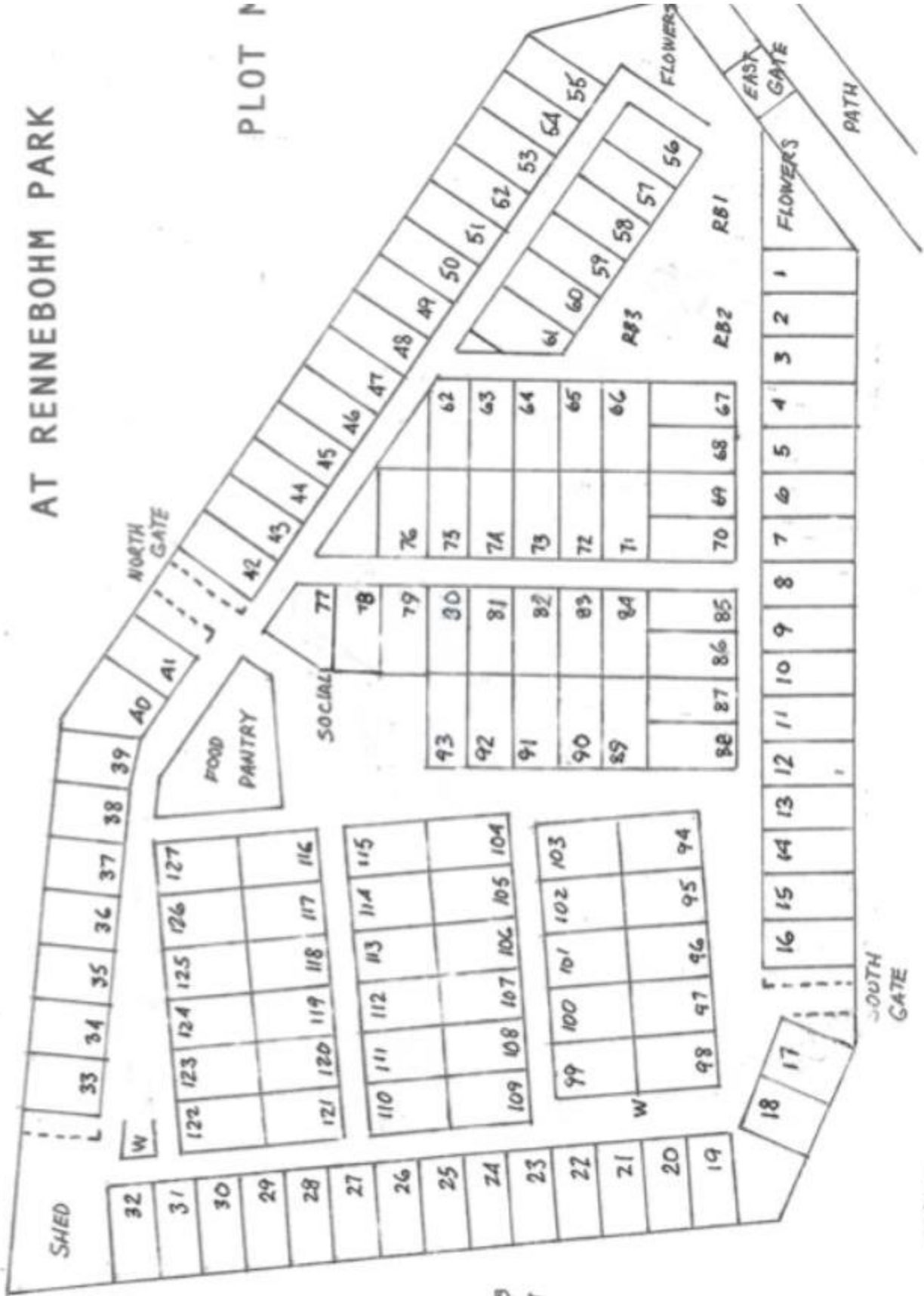

1/13/2019
rev. 4/15/2019